

The Estate Agent People Recommend



22 Stephen Close,  
Twyford  
RG10 0XN

**£259,999**



Wentworth Estate Agents have pleasure to offer a SPACIOUS ONE BEDROOM TERRACED house located in quiet cul de sac on the popular Broad Hinton Development. Within walking distance to Twyford village and mainline train station serving London Paddington and Reading.

The property comprises of living room/dining room with dual aspect windows, kitchen with plenty of eye and base level units and a larger cupboard, double bedroom with dual aspect windows and family bathroom.

Further benefits include private parking, gas central heating, private garden to the side of the property and an additional private garden with space for a shed.

NO ONWARD CHAIN

EPC - C

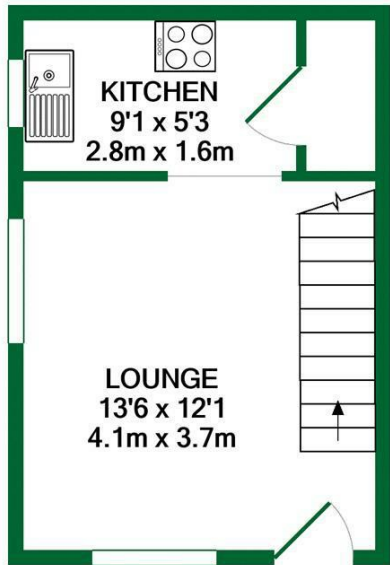

GROUND FLOOR

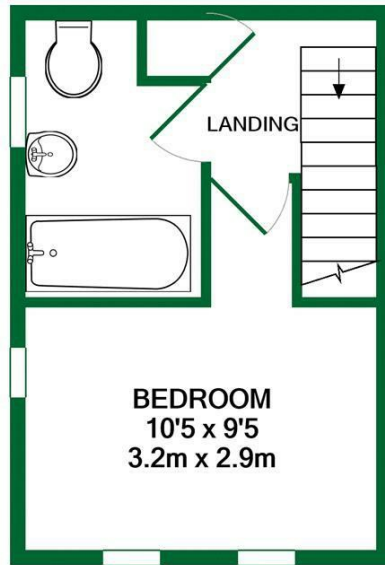

1ST FLOOR

## ACCOMMODATION

- SPACIOUS ONE BEDROOM
- PARKING
- PRIVATE GARDEN
- WALKING DISTANCE TO TWYFORD VILLAGE
- WITHIN A QUIET CUL DE SAC
- NO ONWARD CHAIN



Whilst every attempt has been made to ensure the accuracy of the floor plan contained here, measurements of doors, windows, rooms and any other items are approximate and no responsibility is taken for any error, omission, or mis-statement. This plan is for illustrative purposes only and should be used as such by any prospective purchaser. The services, systems and appliances shown have not been tested and no guarantee as to their operability or efficiency can be given  
Made with Metropix ©2020



The Old Butchers, 15 High Street, Twyford, Berkshire, RG10 9AB  
t: 0118 934 0027 e: twyford@wentworthea.com

IMPORTANT: we would like to inform prospective purchasers that these sales particulars have been prepared as a general guide only. A detailed survey has not been carried out, nor the services, appliances and fittings tested. Room sizes should not be relied upon for furnishing purposes and are approximate. If floor plans are included, they are for guidance only and illustration purposes only and may not be to scale. If there are any important matters likely to affect your decision to buy, please contact us before viewing the property.



wentworth\_ea



wentworthestateagents